

LL01ED-LP70130L Data Sheet

For EDIXEON Single-Color LEDs



Features:

- High efficiency
- Available in 1 beam Patterns
- Optimized for uniform effects
- Lens without Housing

Typical applications :

- Stage Lighting
- Street Lights
- Decorative Light
- Architectural Lighting
- Down Light

Table of Contents

General Information.....	2
General Specifications.....	2
Optical Specifications.....	3
Mechanical Specifications.....	4
Illumination charts.....	5
Package Specifications.....	6
Product Nomenclature.....	7

General Information

- **Compatible Led Type :**

The LL01ED-LP70130L single lens are optimized for Single-Color (Edixeon EDEW 1LS6) Edixeon LEDs from Edison Opto. ⁽¹⁾

- **Beam Angle Type :**

An optimized profile integrate different front shape enable the generation of one lens model: oval beam (70*130deg) ⁽²⁾

- **The Way to Assembly :**

Please fix it when the two holes in the lens and the two screw holes in the MCPCB are at the same point in order to get the best optical effort.

*** Manually installation or if necessary thermal glue are recommended.**

- **Function :**

LL01ED-LP70130L provides exceptional color mixing result with the highest efficiency through careful engineering and precision manufacturing process.

General Specifications

- Lens Material Optical Grade PMMA PC
- Operating Temperature range -40°C ~ + 110°C (upper limit +120°C)
- Storage Temperature range -40°C ~ + 110°C (upper limit +120°C)

*Average transmittance in visible spectrum 400nm~700nm > 90%

Notes:

(1) Edixeon 1LS6 is a trademark of Edison,Inc, for technical information on LEDs, please refer to Edison,Inc, <http://www.edison-opto.com.tw/>

(2) Typical beam divergence will be affected by different color of LEDs.

Optical Specifications [Typical beam Angle and intensity (cd/w) of LL01 lens]

• Edixeon 1LS6 LED

Typical Cone Angle (degree) ⁽³⁾ with Edixeon 1LS6			
Part Number	Red LEDs	Green LEDs	Blue LEDs
LL01ED-LP70130L	--	--	--

The typical cone angle measures where the luminous intensity is 50% of the peak value of intensity. This typical cone varies with LED color due to different chip size and chip position tolerance.

Typical on axis intensity (cd/w) ⁽⁴⁾ with Edixeon 1LS6			
Part Number	Red LEDs	Green LEDs	Blue LEDs
LL01ED-LP70130L	--	--	--

Luminous intensity depends on the flux binning and tolerance of the LEDs. Please refer to the LEDs data sheet for more details on Flux binning and mechanical tolerance.

• Edixeon 1LS6 LED

Typical Cone Angle (degree) ⁽³⁾ with Edixeon 1LS6			
Part Number	White LEDs	Warm white LEDs	
LL01ED-LP70130L	43*132	--	

The typical cone angle the full angle measured where the luminous intensity is 50% of the peak value of intensity. That typical cone varies with LED color due to different chip size and chip position tolerance.

Typical on axis intensity (cd/w) ⁽⁴⁾ with Edixeon 1LS6			
Part Number	White LEDs	Warm white LEDs	
LL01ED-LP70130L	75	--	

Luminous intensity depends on the flux binning and tolerance of the LEDs. Please refer to the LEDs data sheet for more detail on Flux binning and mechanical tolerance

Notes:

(3) The typical divergence will be changed by different color, chip size and chip position tolerance. The typical total divergence is the full angle measured where the luminous intensity is half of the peak value.

(4) The efficiency value listed above is the total value of the whole lens model, the value depends on the total flux of the LED used. Luminous intensity depends on the LEDs flux and its tolerances, for more details of LED flux, please check Edixeon data sheet at <http://www.edison-opto.com.tw/>

Mechanical Specifications

• Usage and Maintenance :

1. If necessary, clean lenses with mild soap, water and soft cloth
2. Never use any commercial cleaning solvents on lenses, like alcohol
3. Please handle or install lenses with wearing gloves, skin oils may damage lens or its optical characteristic.

1. Lens + Leds+MCPCB assembly instruction

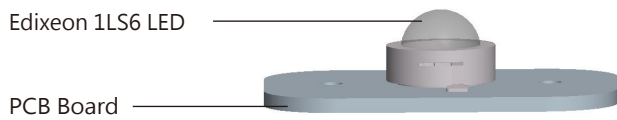
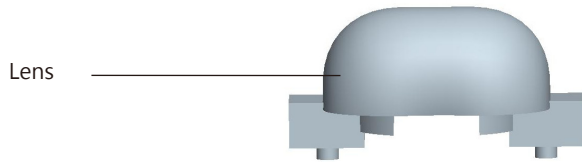

2. View assembly lens with MCPCB:

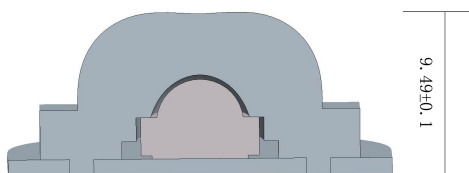

3. Lens dimensions and Top Views:

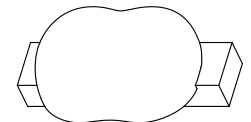
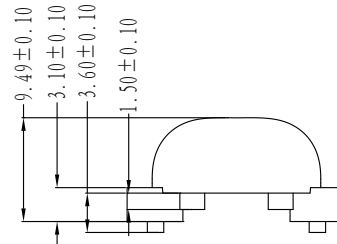
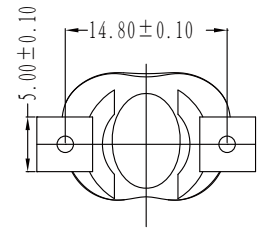
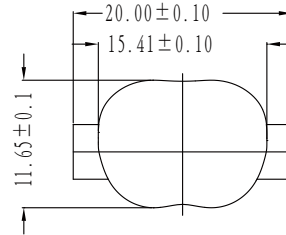

Notes:
 (1) All dimensions are in mm.
 (2) Drawing not to scale.
 (3) Collimator material is PC.

Illumination charts

*Edixeon single white LED: Edixeon 1LS6

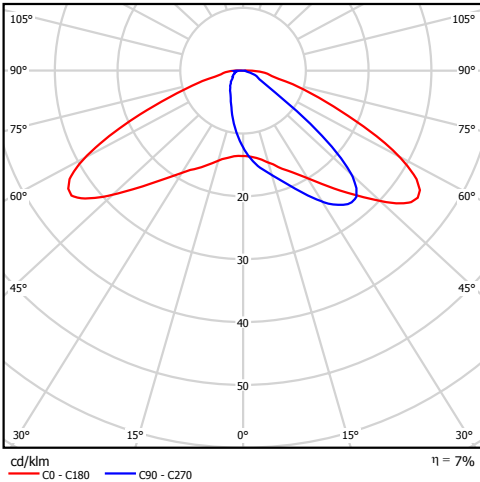
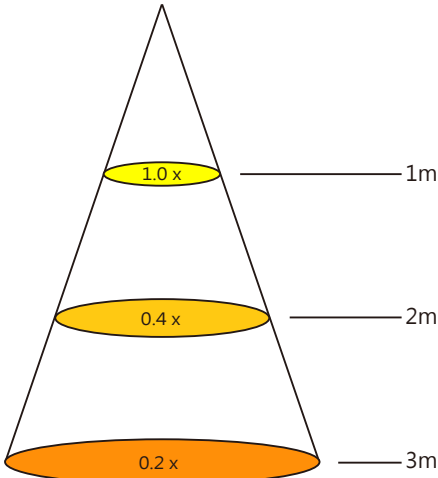
LL01ED-LP70130L	
1. Beam Pattern	
	
2. Light Distribution Curve	
	
3. Illuminance	
	

Notes: The Flux of Edixeon 1LS6 LED is 76 lm

Package

Item	Quantity	Total	Size (long*width* high)
Tray		250pcs	42*50 cm
Outer box	8plastic bag lbox	2000pcs	40*37*21 cm

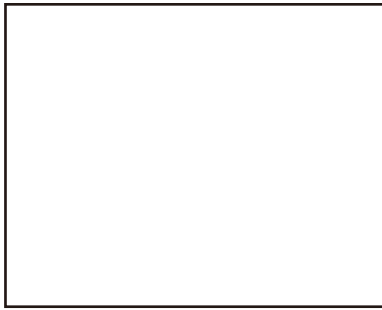

250pcs/tray

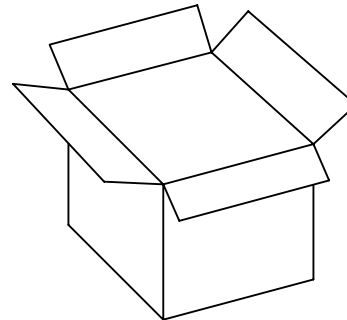
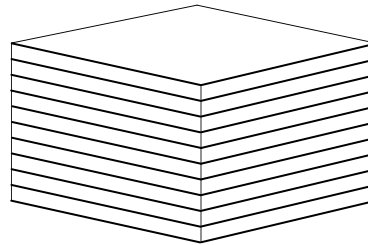

2000pcs/inner box

Product Nomenclature

